

**Polymak**

**ROTARY HAMMER**

**CM-RH-20A**

**INSTRUCTION MANUAL**

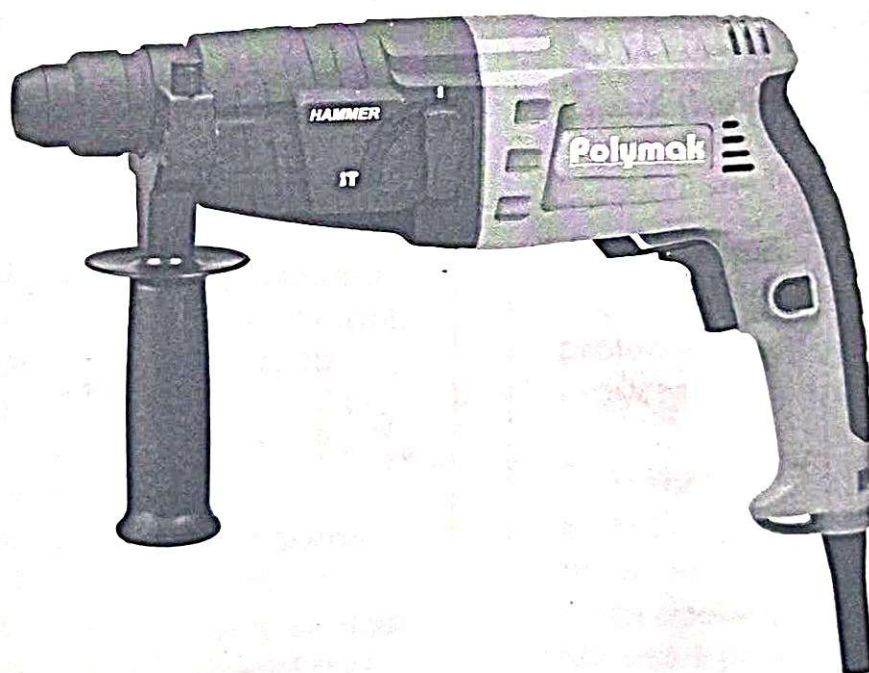

Read and follow all safety precautions in instruction manual

## ORIGINAL INSTRUCTIONS

### GENERAL POWER TOOL SAFETY WARNINGS



**WARNING!** Read all safety warnings and all instructions. Failure to follow the warnings and instructions may result in electric shock, fire and/or serious injury.

Save all warnings and instructions for future reference.

The term "power tool" in the warnings refers to your mains-operated (corded) power tool or battery-operated (cordless) power tool.

#### 1. Work area safety

- a) Keep work area clean and well lit. Cluttered or dark areas invite accidents.
- b) Do not operate power tools in explosive atmospheres, such as in the presence of flammable liquids, gases or dust. Power tools create sparks which may ignite the dust or fumes.
- c) Keep children and bystanders away while operating a power tool. Distractions can cause you to lose control.

#### 2. Electrical safety

- a) Power tool plugs must match the outlet. Never modify the plug in any way. Do not use any adapter plugs with grounded power tools. Unmodified plugs and matching outlets will reduce risk of electric shock.

- b) Avoid body contact with grounded surfaces, such as pipes, radiators, ranges and refrigerators. There is an increased risk of electric shock if your body is grounded.

- c) Do not expose power tools to rain or wet conditions. Water entering a power tool will increase the risk of electric shock.

- d) Do not abuse the cord. Never use the cord for carrying, pulling or unplugging the power tool. Keep cord away from heat, oil, sharp edges or moving parts. Damaged or entangled cords increase the risk of electric shock.

- e) When operating a power tool outdoors, use an extension cord suitable for outdoor use. Use of a cord suitable for outdoor use reduces the risk of electric shock.

- f) If operating a power tool in a damp location is unavoidable, use a residual current device (RCD) protected supply. Use of an RCD reduces the risk of electric shock.

#### 3. Personal safety

- a) Stay alert, watch what you are doing and use common sense when operating a power tool. Do not use a power tool while you are tired or under the influence of drugs, alcohol or medication. A moment of inattention while

operating power tools may result in serious personal injury.

b) Use personal protective equipment. Always wear eye protection. Protective equipment such as dust mask, non-skid safety shoes, hard hat, or hearing protection used for appropriate conditions will reduce personal injuries.

c) Prevent unintentional starting. Ensure the switch is in the off-position before connecting to power source and/or battery pack, picking up or carrying the tool. Carrying power tools with your finger on the switch or energising power tools that have the switch on invites accidents.

d) Remove any adjusting key or wrench before turning the power tool on. A wrench or a key left attached to a rotating part of the power tool may result in personal injury.

e) Do not overreach. Keep proper footing and balance at all times.

This enables better control of the power tool in unexpected situations.

f) Dress properly. Do not wear loose clothing or jewellery. Keep your hair, clothing and gloves away from moving parts. Loose clothes, jewellery or long hair can be caught in moving parts.

g) If devices are provided for the connection of dust extraction and

collection facilities, ensure these are connected and properly used. Use of dust collection can reduce dust-related hazards.

#### 4. Power tool use and care

a) Do not force the power tool.

Use the correct power tool for your application. The correct power tool will do the job better and safer at the rate for which it was designed.

b) Do not use the power tool if the switch does not turn it on and off. Any power tool that cannot be controlled with the switch is dangerous and must be repaired.

c) Disconnect the plug from the power source and/or the battery pack from the power tool before making any adjustments, changing accessories, or storing power tools. Such preventive safety measures reduce the risk of starting the power tool accidentally.

d) Store idle power tools out of the reach of children and do not allow persons unfamiliar with the power tool or these instructions to operate the power tool. Power tools are dangerous in the hands of untrained users.

e) Maintain power tools. Check for misalignment or binding of moving parts, breakage of parts and any other condition that may affect the power tool's operation.

If damaged, have the power tool repaired before use. Many accidents are caused by poorly maintained power tools.

f) Keep cutting tools sharp and clean. Properly maintained cutting tools with sharp cutting edges are less likely to bind and are easier to control.

g) Use the power tool, accessories and tool bits etc. in accordance with these instructions, taking into account the working conditions and the work to be performed. Use of the power tool for operations different from those intended could result in a hazardous situation.

#### 5. Service

a) Have your power tool serviced by a qualified repair person using only identical replacement parts. This will ensure that the safety of the power tool is maintained.



## ADDITIONAL SAFETY POINTS FOR YOUR HAMMER DRILL

1. Remove the plug from the socket before carrying out any adjustment, servicing or maintenance.
2. Fully unwind cable drum extensions to avoid potential overheating.
3. When an extension cable is required you must ensure it has the correct ampere rating for your power tool and that it is in a safe electrical condition.
4. Ensure your mains supply voltage is the same as your tool rating plate voltage.
5. Your tool is double insulated for additional protection against a possible electrical insulation failure within the tool. 
6. Always check walls and ceilings to avoid hidden power cables and pipes.
7. After long working periods, external metal parts and accessories could be hot.
8. Wear eye protection when operating this tool.
9. Wear ear protectors with hammer drill. Exposure to noise can cause hearing loss.
10. Maintain a firm grip on the handle when you are working. Always use the auxiliary handles supplied with the tool. Loss of control can cause personal injury.
11. Hold tool by insulated gripping surfaces when performing an operation where

the cutting tool may contact hidden wiring. Contact with a "live" wire will also make exposed metal parts of the tool "live" and result in operator injury.

12. Do not use the drill near water.

## SYMBOLS



To reduce the risk of injury, user must read instruction manual



Double insulation



Warning



Wear ear protection



Wear eye protection



Wear dust mask

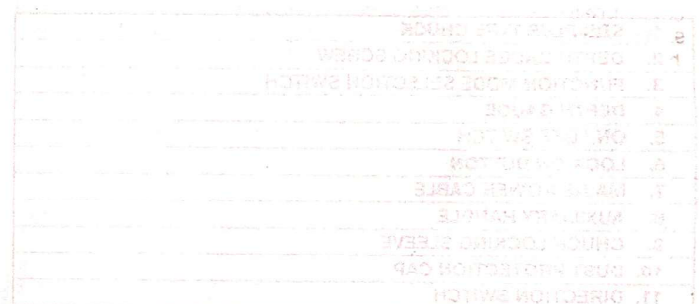

COMPONENT LIST

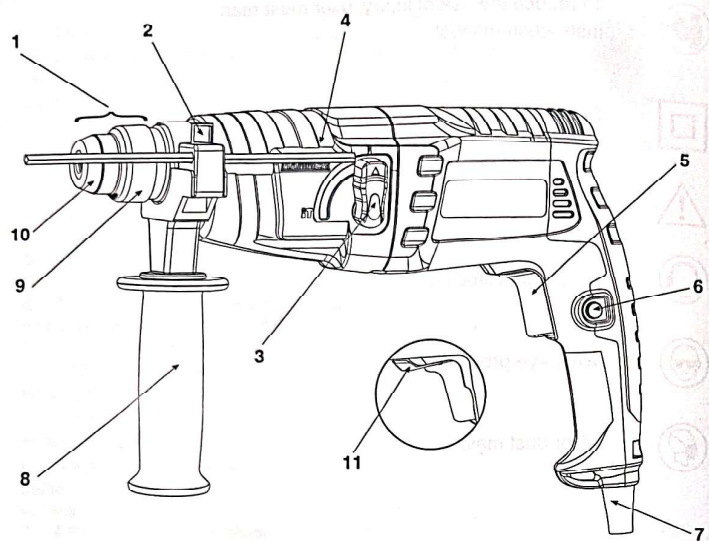

1	SDS-PLUS TYPE CHUCK
2	DEPTH GAUGE LOCKING SCREW
3	FUNCTION MODE SELECTION SWITCH
4	DEPTH GAUGE
5	ON / OFF SWITCH
6	POWER CABLE
7	AUXILIARY HANDLE
8	DRILL LOCKING SLEEVE
9	DUST PROTECTION CAP
10	DIRECTION SWITCH

TECHNICAL DATA

Rated voltage	220V~50Hz	
Rated power input	800W	
No load speed	0-1200/min	
Impact rate	0-5000/min	
Impact energy	1.5J	
Max drilling capacity in	Steel	13mm
	Masonry	22mm
	Wood	30mm
Protection class	□/II	
Machine weight	2.3kg	

ACCESSORIES

Auxiliary handle	1
Depth gauge	1
SDS drill bits:	
6X150MM	1
8X150MM	1
10X150MM	1

We recommend that you purchase accessories. Choose the type according to the work you intend to undertake. Refer to the accessory packaging for further details. Our personnel can assist you and offer advice.

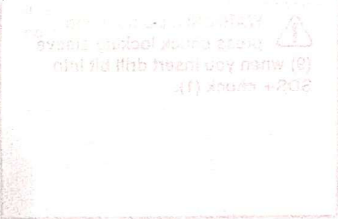

## OPERATION INSTRUCTIONS

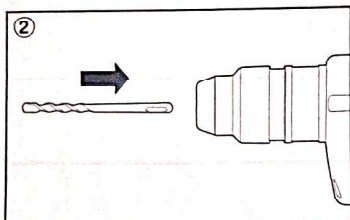
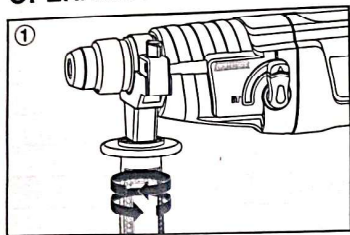

**NOTE:** Before using the tool, read the instruction book carefully.

### INTENDED USE

The machine is intended for hammer drilling in concrete, brick and stone. It is also suitable for drilling without impact in wood, metal, ceramic and plastic.

### 1. ADJUSTING THE AUXILIARY HANDLE (See ①)

For your personal safety we recommend using the auxiliary handle at all times.

To adjust the handle, loosen the bottom of the handle anti-clockwise and rotate the handle around the handle collar until the handle is in the desired position. Tighten fully.

### 2. FITTING SDS+ DRILL BIT (See ②)

Clean and lightly oil the drill bit before inserting. Insert the drill bit with a twisting motion until it latches. The drill bit locks itself. Check the drill bit is locked in place by pulling on it.

**WARNING:** Do not need press chuck locking sleeve (9) when you insert drill bit into SDS+ chuck (1).

### 3. REMOVE SDS+ DRILL BIT (See ③)

Press the chuck locking sleeve (9) in the direction of arrow firstly, then hold the drill bit and remove it from SDS+ chuck.

### 4. OPERATING THE SAFETY ON/OFF SWITCH

Press the On/Off Switch(5) in for operation, release the switch to stop. (See ④)

#### Reversing the Rotational Direction

The rotational direction switch 11 is used to reverse the rotational direction of the machine. However, this is not possible with the On/Off switch 5 actuated.

**Right rotation:** Push the rotational direction switch 11 rightward to the stop.

**Left rotation:** Push the rotational direction switch 11 leftward to the stop.

Set the direction of rotation for hammer drilling, drilling and chiselling always to right rotation.

In left rotation, the On/Off switch cannot be locked.

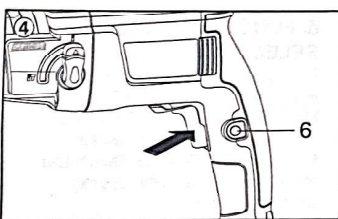
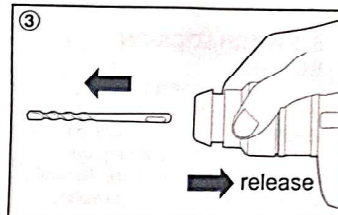

### 5. SWITCH LOCK-ON BUTTON

Depress the On/Off Switch (5) then the Lock On Button (6); release the On/Off Switch first and the lock-on button second. Your switch is now locked on for continuous use. To switch off your tool just depress and release the On/Off Switch.

### 6. FUNCTION MODE SELECTION

The operation of the gearbox for each application is set with the Function Mode Selection Switch (3). To change between functions, depress the Function Mode Selection Switch and rotate the selector to the desired operating mode.



For simultaneous drilling and impacting of concrete or masonry, choose the Hammer drilling position.



For drilling into steel, wood and plastics choose the Rotary drilling position.

**WARNING:** The operating mode selector switch may be adjusted only at a standstill.

### 7. USING THE DEPTH GAUGE(4)

1. Rotate the Depth Gauge Locking Screw(2) for Depth Gauge anti-clockwise, insert Depth Gauge into the handle (See ⑤).
2. Adjust the Depth Gauge to desired depth.
3. Rotate the handle clockwise to tighten the Depth Gauge.

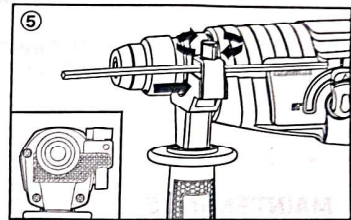



## WORKING HINTS FOR YOUR TOOL

1. Reduce the pressure on the drill bit when it is about to break through. This will prevent the drill from jamming.
2. When drilling a large hole, first drill a pilot hole using a smaller drill bit.
3. Always apply pressure to your drill bit in a straight line, and if possible at right angles to the workpiece.
4. Never change the operating mode whilst the drill is running.
5. Do not apply excessive pressure to the tool when drilling. Excessive force does not speed up the work.

## MAINTENANCE

**Remove the plug from the socket before carrying out any adjustment, servicing or maintenance.**

There are no user serviceable parts in your power tool. Never use water or chemical cleaners to clean your power tool. Wipe clean with a dry cloth. Always store your power tool in a dry place. Keep the motor ventilation slots clean. Keep all working controls free of dust. Occasionally you may see sparks through the ventilation slots. This is normal and will not damage your power tool.

If the supply cord is damaged, it must be replaced by the manufacturer, its service agent or similarly qualified persons in order to avoid a hazard.

## TROUBLESHOOTING

1. If your hammer does not start, check the plug on the mains supply first.
2. If your hammer work efficiency is too low, please add some grease in the grease hole.
3. If your hammer use in low efficiency, please check whether the tool is blunt.
4. If the tool can not be rectified return the tool to an authorized dealer for repair.



# Polymak

**Polymak Tool (India) Pvt. Ltd**

186/187, P.H Road, Alsa Towers, Kilpauk,  
Chennai-600 010,

Tel. : +1800-309-4535

E-mail : [info@polymak.co.in](mailto:info@polymak.co.in)

Visit us at: [www.polymak.co.in](http://www.polymak.co.in)